

ANNOUNCING THE M-20 MATERIAL PROCESSOR

NPK is pleased to announce the addition of the New Model M-20 to our Material Processor line. Manufactured from high-strength, abrasion-resistant steel, this rugged design accomplishes trouble-free, extended life with reinforced shields protecting cylinder rods. NPK's exclusive Pressure Intensifier System boosts power by amplifying cylinder pressure and reducing cycle time. The full 360° power rotation provides an effective angle of attack for any job wherever the location.

The availability of four different interchangeable jaw assemblies provides superior results and sizable cost savings when compared to purchasing different attachments to achieve the same results. The M-20 can be mounted on 20-25 ton excavators, effectively expanding the compatibility of our full line of Material Processors (including the M-28 and M-38) with any excavator from 20 tons to 55 tons.

NPK Material Processors are an efficient solution for concrete, steel and rebar processing, building and bridge demolition, and recycling. NPK's Material Processor allows the customer to utilize one unit to efficiently and effectively demolish and/or process a variety of materials.

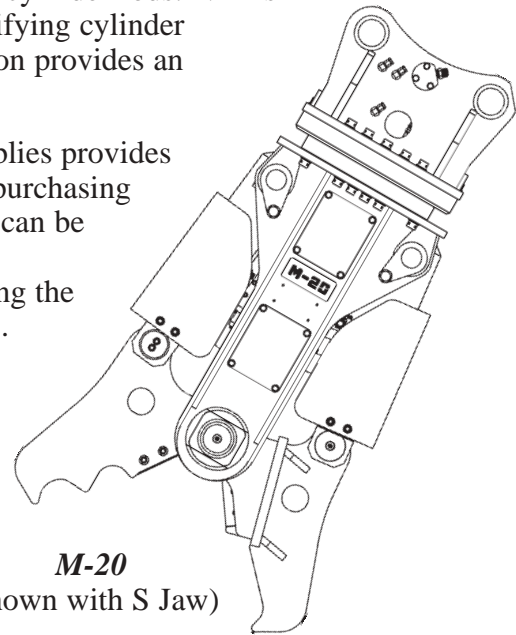

M-20
(shown with S Jaw)

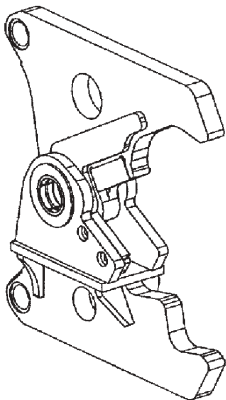

The **S Jaw (Cracking)** allows for fast demolition of concrete structures and some cast materials up to 37" thick.

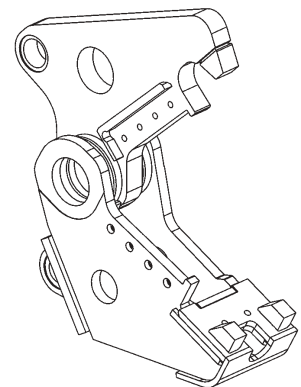

The **C Jaw (Combo-Cutter)** is highly versatile and can be utilized for quick demolition of concrete and light steel structures.

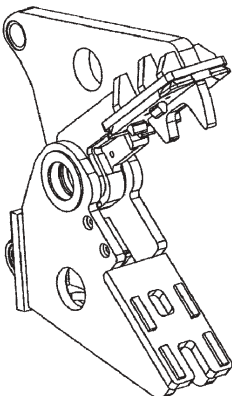

The **G Jaw (Pulverizing)** effectively pulverizes concrete up to 30" thick, effectively separating the rebar in the process.



The **K Jaw (Shearing)** can be used in a variety of steel cutting applications, from steel processing to building demolition.